

BUILDING C — NOW AVAILABLE



FLINT COMMERCE CENTER

1,019,520 SF | 509,760 SF AVAILABLE | ±2,500 SF SPEC OFFICE SPACE | READY FOR OCCUPANCY | DE SOTO, KS

NEWMARK
ZIMMER

FLINT
DEVELOPMENT

Mark C. Long
816-512-1011
mlong@nzimmer.com

John F. Hassler
816-268-4208
jhassler@nzimmer.com

Scott E. Bluhm
816-268-4224
sbluhm@nzimmer.com

MASTER SITE PLAN

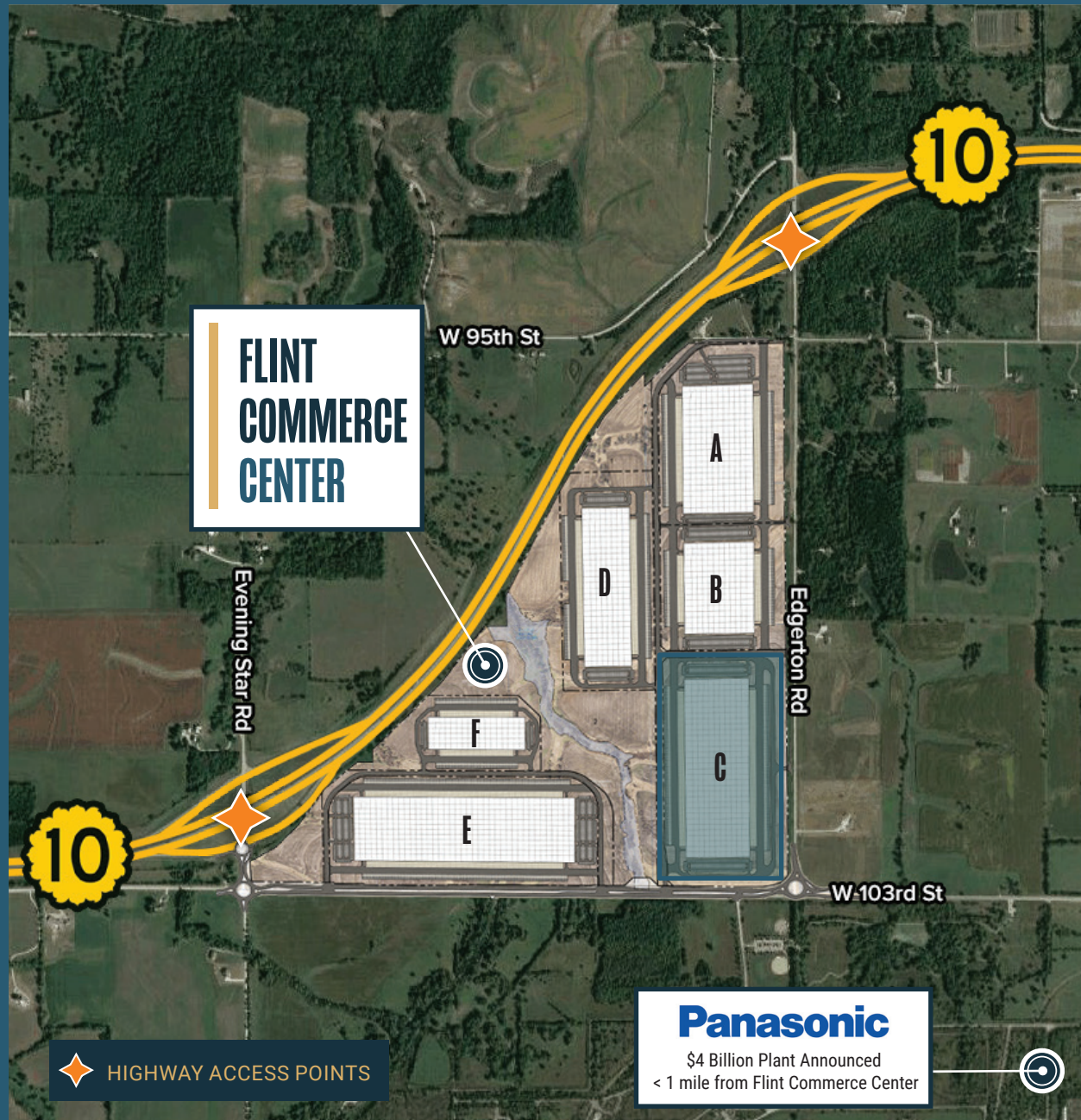

FLINT COMMERCE CENTER FEATURES

- State of the art crossdock, distribution buildings
- Business friendly community
- Zoned: Industrial
- Fixed Pilot: \$0.34/SF (\$0.29 for manufacturing uses)
- Class-A tilt wall construction

RECENT SITE IMPROVEMENTS

- Street/Transportation: new 3 lane Edgerton Road & 103rd Street with 6 access points
- Edgerton Road Improvements, completed Q2 2023
- 103rd Street Improvements, Q4 2024 completion
- High Pressure Gas Main Extension (Atmos Gas), Q2 2024 completion
- Transmission and Distribution Electrical Upgrades (Evergny), Q2 2024 completion
- Evergny Substation Upgrades, Q4 2023 completion
- Public Sewer Improvements, Q2 2024 completion

SITE PLAN – BUILDING C

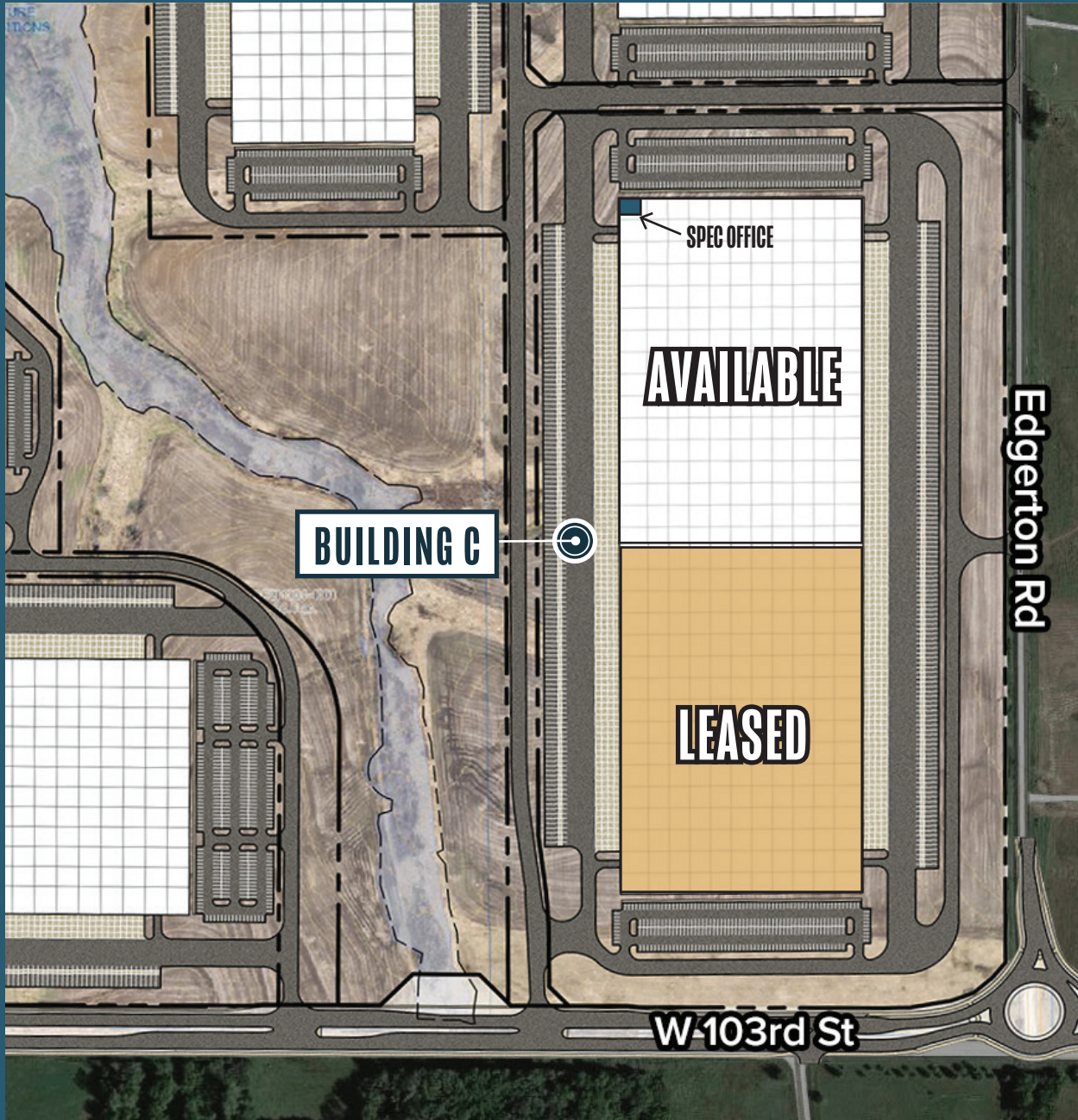

BUILDING C OVERVIEW:

- Ready for Occupancy
- ± 509,760 SF available
- ± 2,500 SF spec office space
- 40' minimum clear height
- 50 dock doors
- 61 future dock door positions
- 2 drive-in doors
- 254 car parking stalls
- 251 trailer parking stalls
(Total on-site / 128 East / 123 West)
- 4000A main electrical service
- Tax abatement in place
- Inquire with broker for lease rate

VACANCY SPEC OFFICE AREA – UNDER CONSTRUCTION

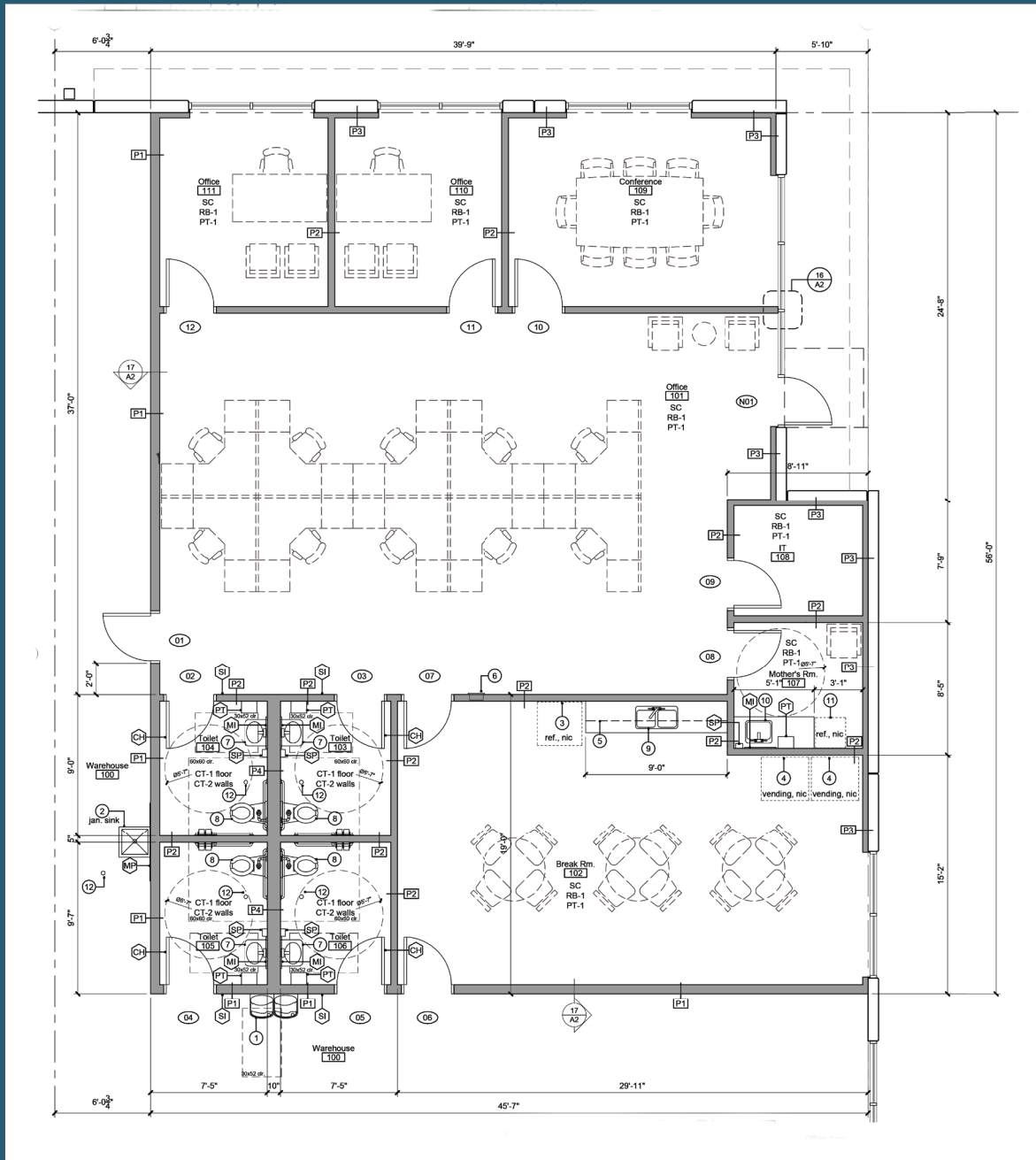

BUILDING PHOTOS & RENDERING



BUILDING DETAILS

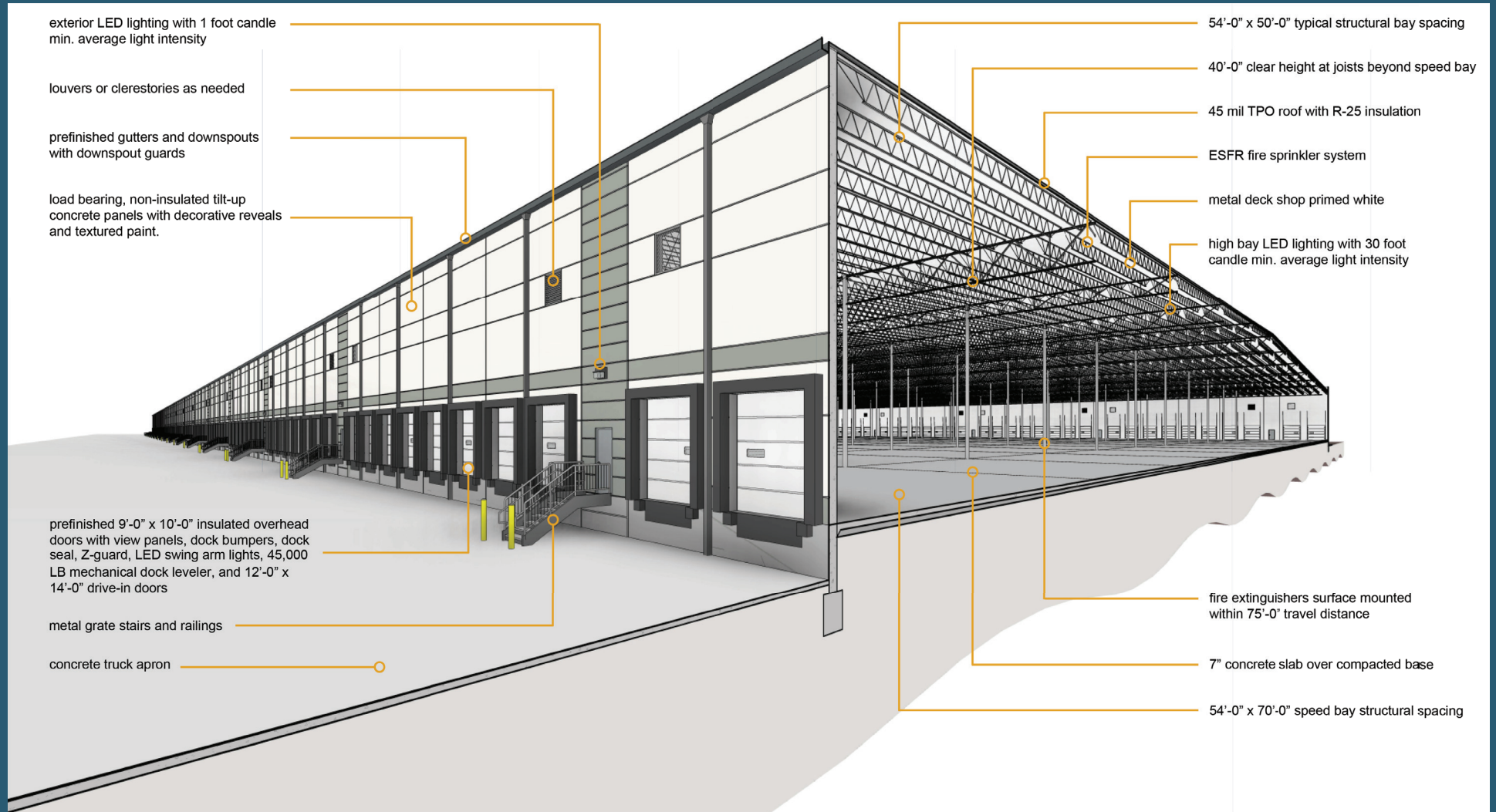

STRATEGIC SITE LOCATION

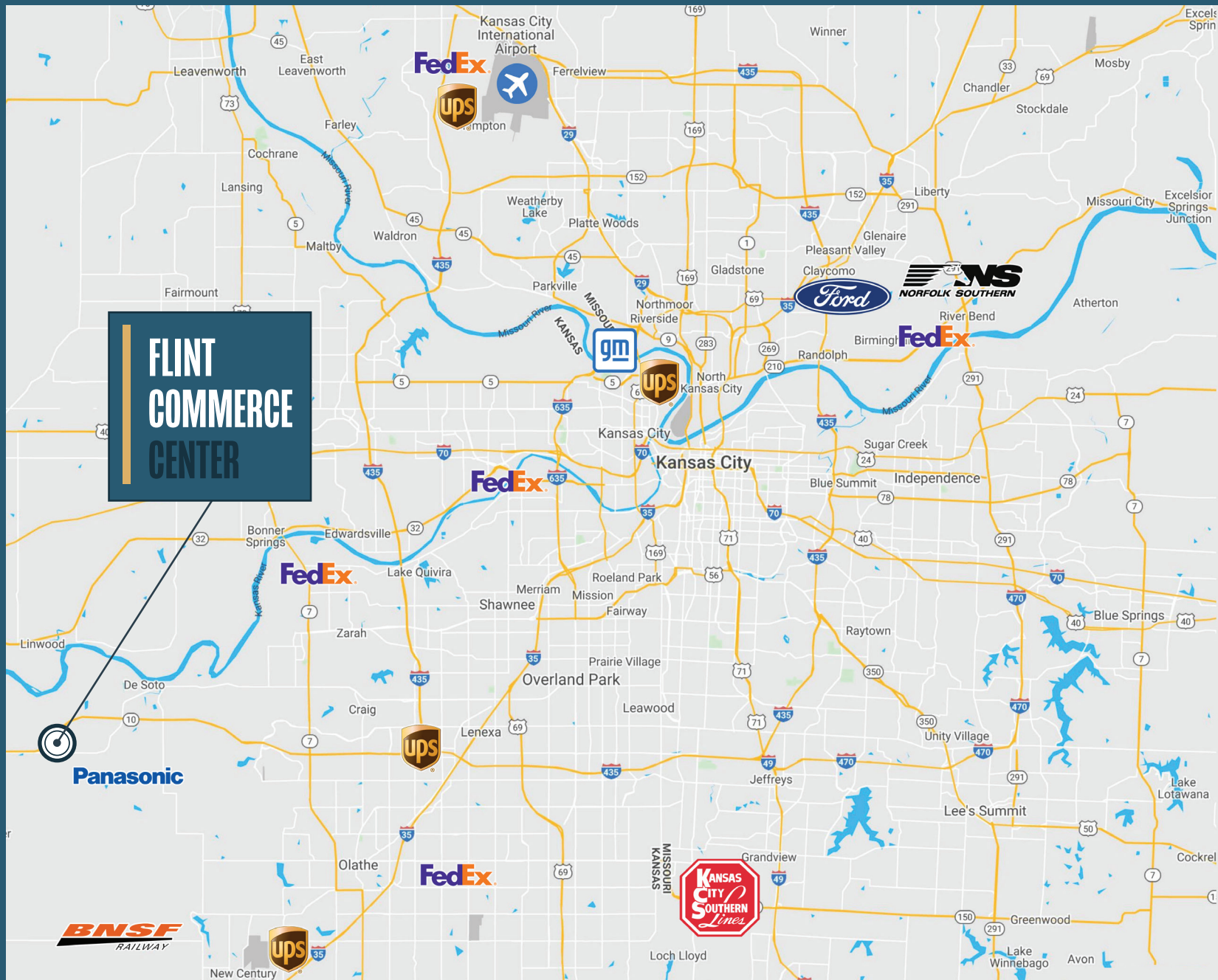

TRANSPORTATION INFRASTRUCTURE

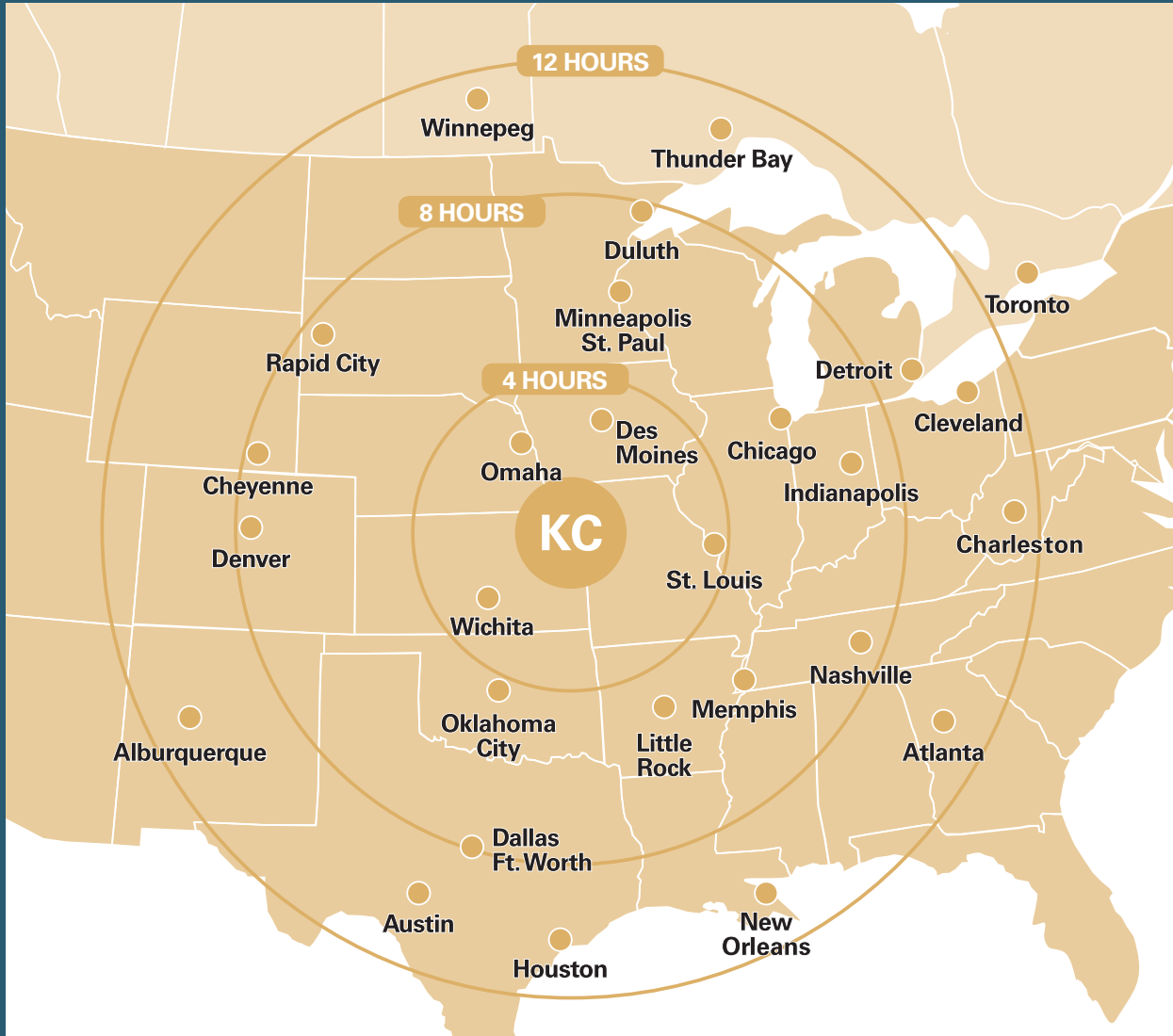

Largest rail center in US by tonnage

4 intermodal centers

4 class 1 rail lines

Located at the intersection of four major U.S. highways

85% of US Population can be reached in 1-2 day truck drive

30% more interstate miles per capita than any other city in the nation
