



Downtown
OKC

**295,193 SF
AVAILABLE**

Leased

Will Rogers Business Park

**415,981 SF
AVAILABLE**

S Council Rd.

NEW INDUSTRIAL PARK | FOR LEASE
SW 29TH & S COUNCIL RD., OKLAHOMA CITY, OK

BRETT PRICE, CCIM, SIOR
bprice@newmarkrp.com
C: 405.613.8380

KRIS DAVIS, SIOR
kgdavis@newmarkrp.com
C: 405.202.9525

KARLEY HARPER
kharper@newmarkrp.com
C: 405.371.3498



NEWMARK
ROBINSON PARK



DEVELOPMENT OVERVIEW

OKC Logistics Park is a new industrial park in the southwest submarket of Oklahoma City just 2 miles south of I-40, 1.5 miles north of Hwy 152, and less than 5 miles from OKC Will Rogers International Airport. Notable surrounding companies include Hobby Lobby, Amazon, Wal-Mart, FedEx, and Rexel.

The park features two spec buildings totaling 1,006,931 square feet on 58 acres± with frontage along SW 29th and S Council Rd.

PROPERTY HIGHLIGHTS



Southwest
Submarket



Surrounding
International Tenants



New
Construction



Cross Dock
Facility



DEVELOPMENT DETAILS

Total Development SF	1,006,931 SF
Lease Rate	Contact Broker
Available SF	711,174 SF
Lot Size	58 Acres±
Zoning	I-3
Market	Oklahoma City
Submarket	Southwest
Cross Streets	SW 29th St. & S Council Rd.

BUILDING OVERVIEWS

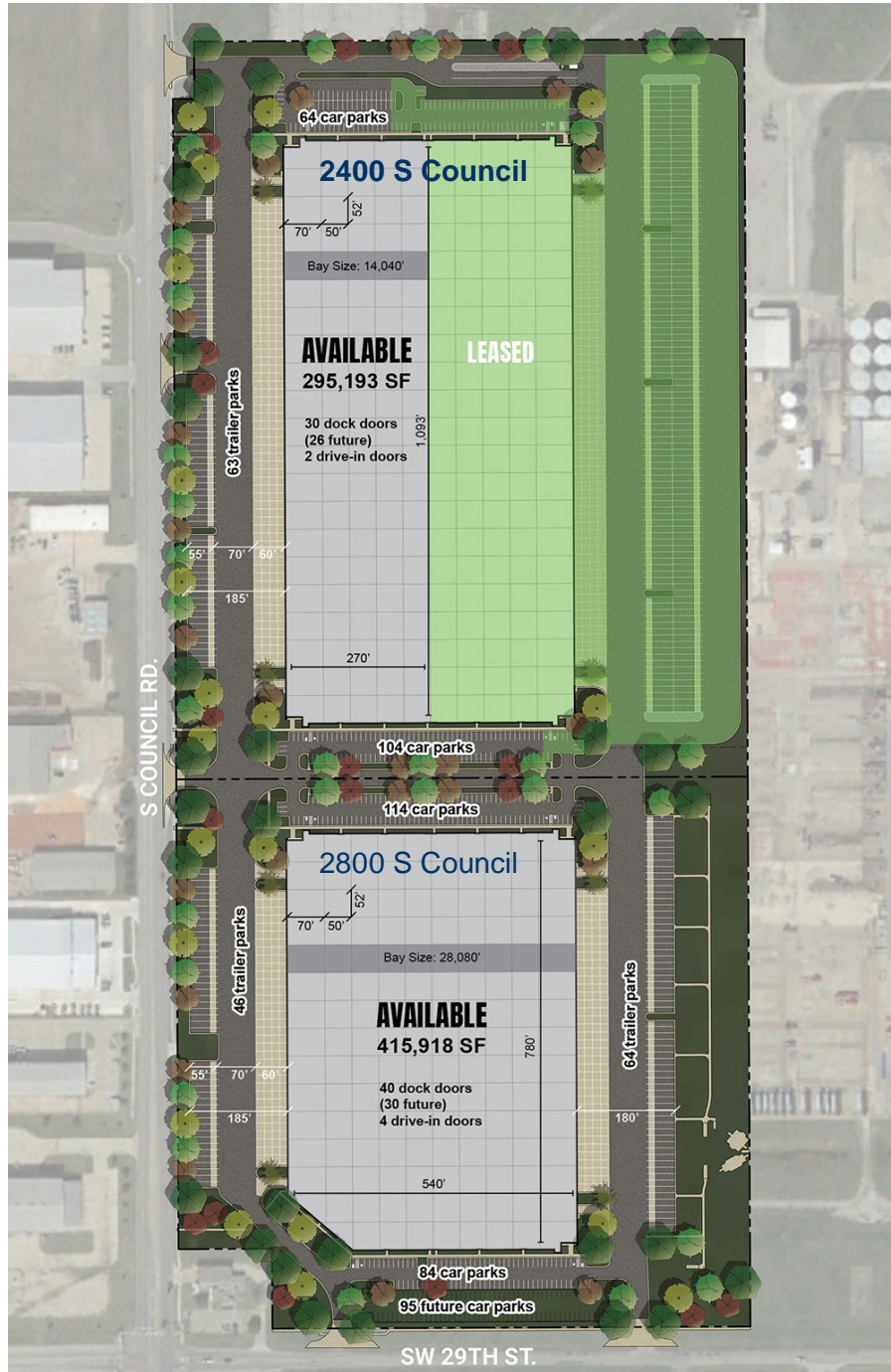

2400 S COUNCIL RD.

Building SF	590,950 SF (540' x 1,093')
Available SF	295,193 SF Available (270' x 1,093')
Column Spacing	52' x 50' with 70' speed bay
Bay Size	14,040'
Clear Height	36'
Drive-in Doors	2 drive-ins
Dock Doors	30 (26 future)
Dock Levelers	(30) 45k lb. mechanical pit levelers
Truck Court	185'±
Trailer Parks	63
Car Parks	168
Slab Construction	7" unreinforced 4,000 PSI
Fire Protection	ESFR
Electrical Available	2000 amps, 480/277V
Lighting	LED, 30 F.C.



BUILDING OVERVIEWS

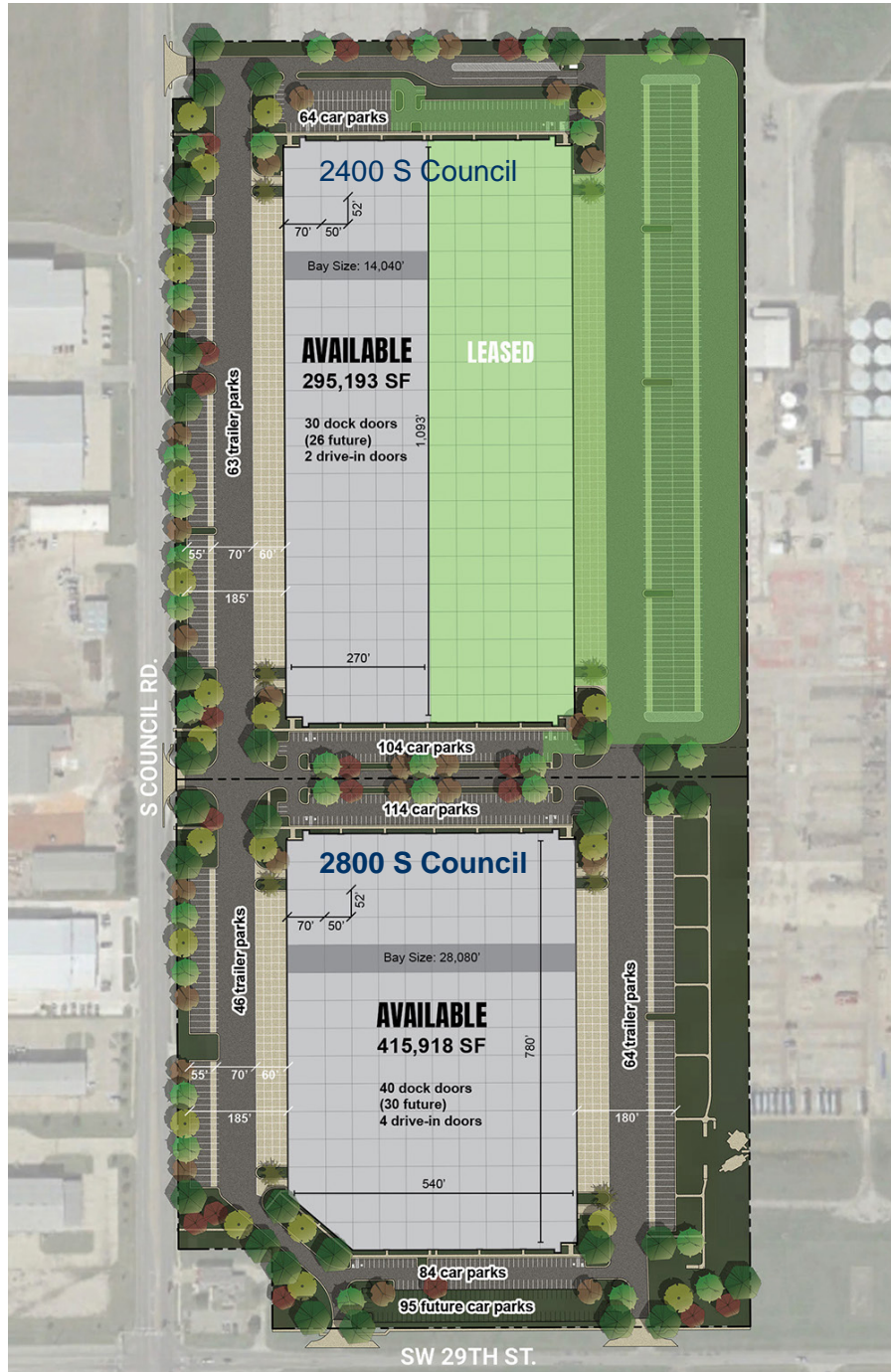

2800 S COUNCIL RD.

Building SF	415,981 SF (540' x 780')
Available SF	415,981 SF
Column Spacing	52' x 50' with 70' speed bay
Bay Size	28,080'
Clear Height	36'
Drive-in Doors	4
Dock Doors	40 (30 future)
Dock Levelers	(40) 45k lb. mechanical pit levelers
Truck Court	180'± - 185'±
Trailer Parks	110
Car Parks	198 (95 future)
Slab Construction	7" unreinforced 4,000 PSI
Fire Protection	ESFR
Electrical Available	4000 amps, 480/277V
Lighting	LED, 30 F.C.



SECTION EXHIBIT

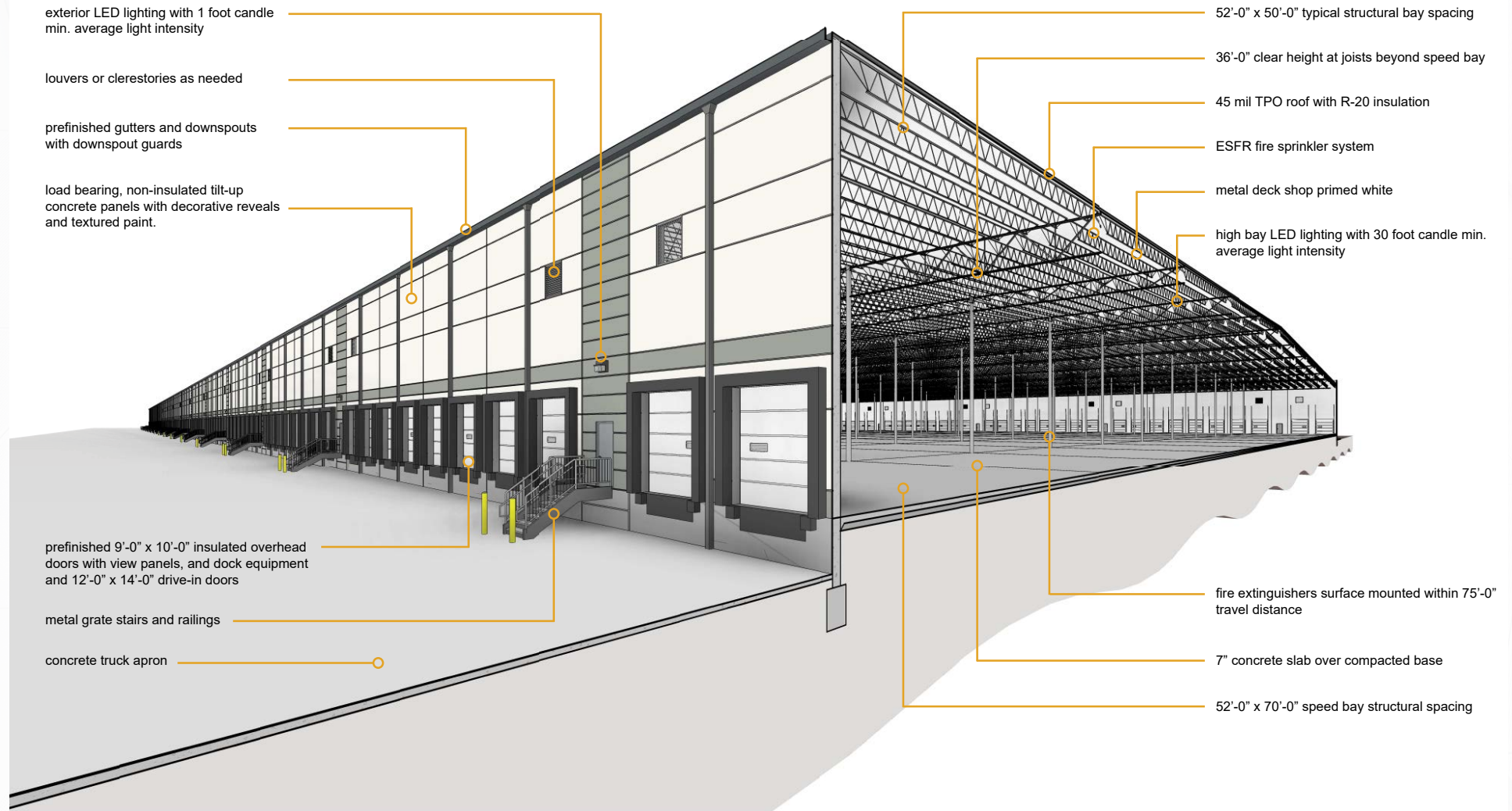



Downtown
OKC

**295,193 SF
AVAILABLE**

Leased

**415,981 SF
AVAILABLE**

Will Rogers Business Park

S Council Rd.

